

## REMOVAL AND INSTALLATION

### Injection Control Pressure (ICP) Sensor

#### Removal

##### All vehicles

1. With the vehicle in NEUTRAL, position it on a hoist. For additional information, refer to Section 100-01.

##### Vehicles with automatic transmission

2. Remove the transmission fluid level indicator.
3. Remove the retaining nut and disconnect the transmission fluid fill tube from the stub tube and position it aside.

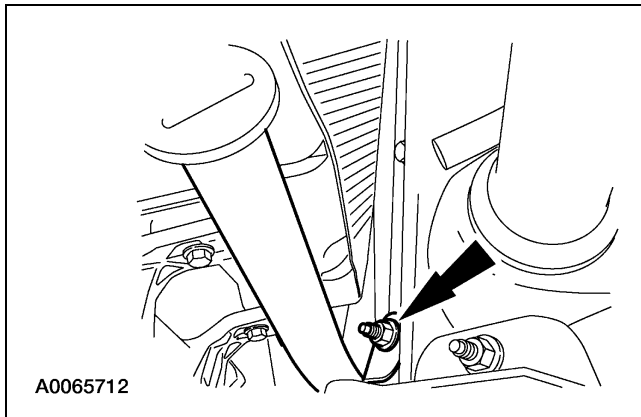

##### All vehicles

4. Raise the vehicle.
5. Remove the bolts and the turbocharger heat shield.

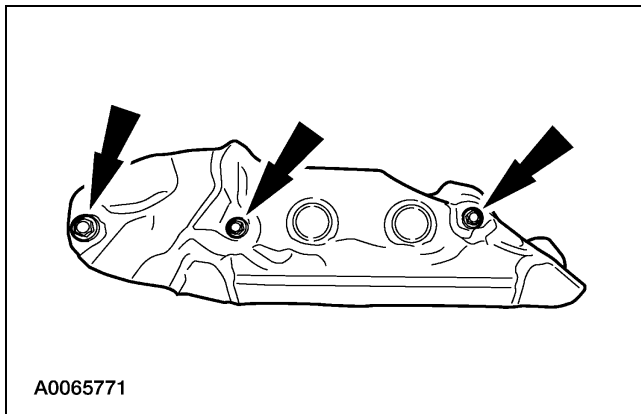

6. **NOTE:** It will be necessary to position the heat wrap aside.

Disconnect the injection control pressure (ICP) sensor electrical connector.

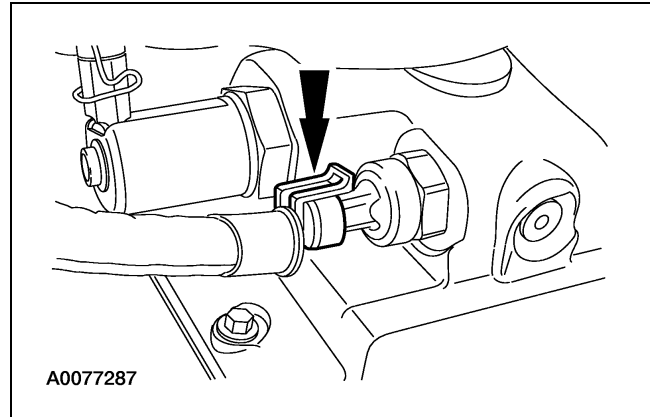

7. **NOTE:** Use a 1-1/16 inch 12 pt. deep flare nut crowfoot wrench, such as a Snap-On® AN850817B, GAN850817B or equivalent, to remove the sensor.

Remove the ICP sensor.

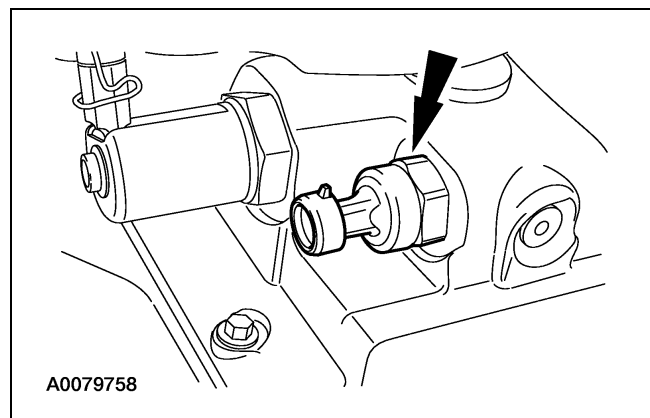

**REMOVAL AND INSTALLATION (Continued)****Installation****All vehicles**

1. **NOTE:** Verify the ICP sensor has the O-ring in place.

Install the ICP sensor.

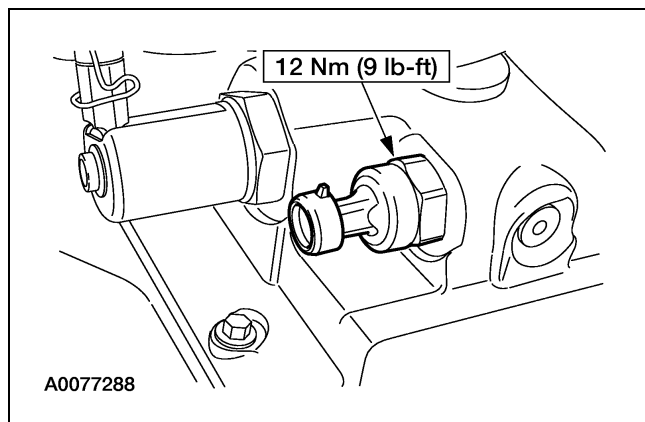

2. Connect the ICP electrical connector.
  - Position the heat wrap back over the electrical connector.

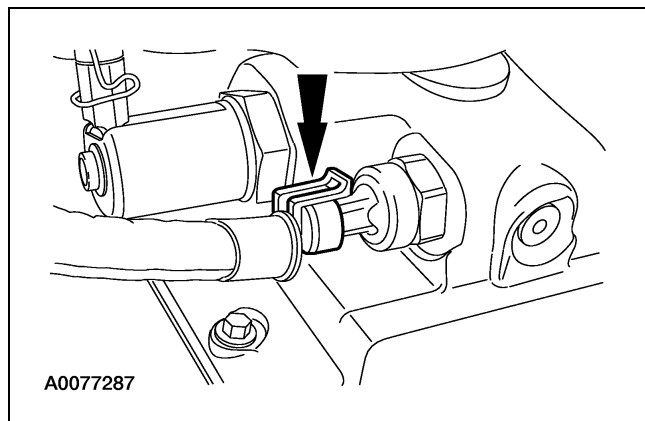

3. **NOTE:** Engine removed for clarity.  
Install the turbocharger heat shield and bolts.

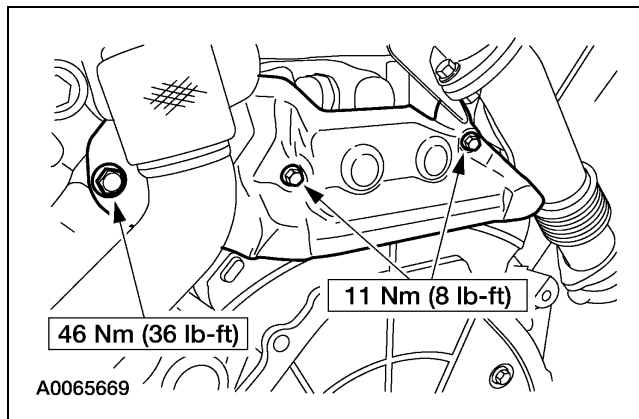
**Vehicles with automatic transmission**

4. Partially lower the vehicle. Working from outside the right wheel area, engage the transmission fluid fill tube to the stub tube.
5. Lower the hoist.
6. Install the fluid fill tube retainer nut.

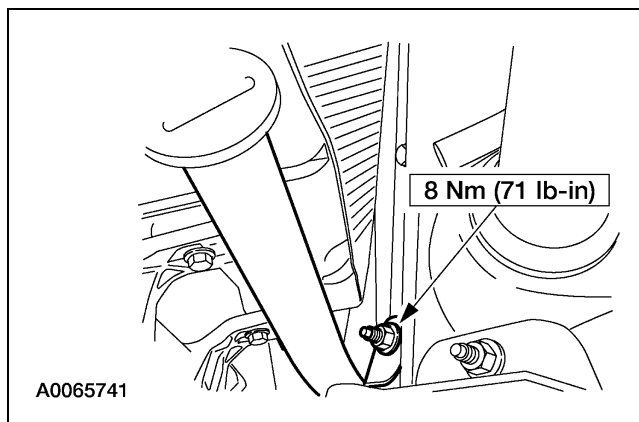

7. Install the transmission fluid level indicator.